

# PLB-PHD



DOWNLOAD  
THE BROCHURE



WATCH THE  
VIDEO

**SIMEX**  
• patented •

## PLANERS

### category

2 - 22 TON



Mini Exc.



Midi Exc.



Exc.



Backhoe

### models

PLB 200 | PLB 300 | PLB 400  
PLB 450 | PLB 600 | PHD 350 | PHD 450



Designed to mill pre-set sections on hard and compact surfaces, the PLB and PHD planers for excavators are able to **remove the entire layer of asphalt or cement** in preparation for trenching, or are used to **scarify deteriorated sections** for later resurfacing. These planers for excavators can work on horizontal, vertical or sloped surfaces.



**A** Manual or hydraulic depth adjustment (optional).

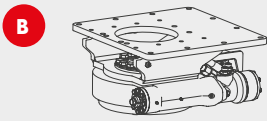

**360° HYDRAULIC ROTATION (OPTIONAL):**  
activated from the cabin, allows milling in any position, even in the most difficult-to-reach spots.

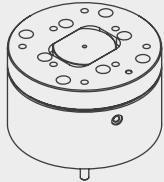

**135° MECHANICAL ROTATION WITH HYDRAULIC LOCKING (OPTIONAL):**  
available on models from PLB 200 to PHD 450.  
Does not require additional hydraulic control.

**C** **PERFORMER** allows the operator to optimize the equipment's performance according to the forward speed of the construction machine.

**D** Nebulizer kit (optional)

**E** Boom-planer connection support pivoted on same rotation axis as milling drum.

**F** Motor in direct drive with the drum.

**G** Independent RH-LH depth adjustment (PHD 350 and PHD 450).



**AVAILABLE DRUMS:**



**STANDARD**



**CEMENT DRUM**  
Reduced pitch compared with standard drum

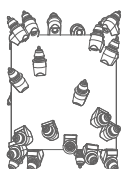

**SPECIAL DRUM**  
For widths and/or depths other than standard

**AVAILABLE TEETH:**



**FOR ASPHALT**



**FOR CEMENT**

**AVAILABLE DISKS:**



**CUTTING DISK**



**VAULT PLANING**

The PLB and PHD swing planers ensure great versatility as they can work on any surface, including vertical and sloped. Such as in vault planing for creating tracks and recesses, to accommodate cables of various kinds or pipes. The planers for excavators ensure scarification depth and uniformity along the tunnel profile.

**CONSTANT PLANING DEPTH**

Thanks to the swinging support pivoted on the same rotation axis as the milling drum, the attachment maintains a perfect planing surface in any condition, regardless of ground contour or the position of the attachment with respect to the prime mover.

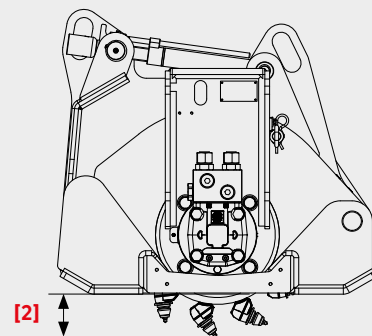
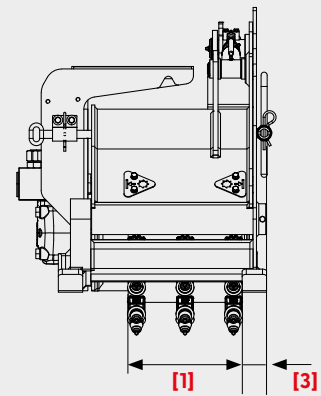



### PLB 350 and PHD 450: INDEPENDENT DEPTH ADJUSTMENT

Independent RH-LH depth adjustment allows the slide on the opposite side of the motor to be height-adjusted independently. This ensures perfect surfaces with side-by-side passes

**SIMEX**  
• patented •

TECHNICAL DATA	SINGLE DEPTH						DOUBLE DEPTH	
		PLB 200	PLB 300	PLB 400	PLB 450	PLB 600	PHD 350	PHD 450
Recommended excavator weight (*)	ton	2 - 4	3 - 7	6 - 9	8 - 13	16 - 22	6 - 9	10 - 16
	lbs	4400 - 8800	6600 - 15400	13000 - 20000	17600 - 29000	35000 - 48400	13000 - 20000	22000 - 35000
<b>STANDARD DRUM</b>								
Width	mm	200	300	400	450	600	350	450
	inch	8	12	16	18	24	14	18
Depth	mm	0 - 70	0 - 100	0 - 120	0 - 150	0 - 200	0 - 120	0 - 180
	inch	0 - 3	0 - 4	0 - 5	0 - 6	0 - 8	0 - 5	0 - 7
<b>SPECIAL DRUMS UPON REQUEST</b>								
Width [1]	mm	50 - 250	50 - 300	50 - 400	75 - 450	75 - 600	50 - 350	75 - 450
	inch	2 - 10	2 - 12	2 - 16	3 - 18	3 - 24	2 - 14	3 - 18
Max. depth [2]	mm	125	130	150	200	250	150	220
	inch	5	5	6	8	10	6	9
Independent RH-LH depth adjustment		-	-	-	-	-	standard	standard
Min. distance from footpath [3]	mm	40 (20*)	50 (25*)	50 (25*)	60 (30*)	75 (40*)	50 (27*)	75 (40*)
	inch	1.6 (0.8*)	2 (1*)	2 (1*)	2.4 (1.2*)	2.6 (1.4*)	2 (1*)	3 (1.4*)
Swinging support rotation angle		120°	127°	118°	120°	105°	118°	102°
Operating weight	kg	185	390	515	710	1150	530	900
	lbs	407	860	1130	1560	2530	1160	1980
Required oil flow	l/min	30 - 50	45 - 75	55 - 90	75 - 140	120 - 200	55 - 90	90 - 140
	gpm	8 - 13	12 - 20	15 - 24	20 - 37	32 - 53	15 - 24	24 - 37

\* The installer is responsible for ensuring that the equipment meets the excavator's specifications and weight requirement. \* Upon request. Simex does not accept responsibility or liability for the information provided. Technical modifications may vary without prior notice.